



LED AIRPORT BEACON LIGHT

	110-230 VAC	24 VDC
---	-------------	--------



		Compliance: ICAO Annex 14 Vol. I (7th. Edition, July 2016)
---	---	--

FEATURES

- LED technology
- Flashing white, night mode
- 10+ years lifespan

APPLICATION

LED Airport Beacon shall be provided where the airport, due to the location or high background luminance, cannot be easily identified from the air by other identification means.

TECHNICAL SPECIFICATIONS

Optical Features		Mechanical Features	
	<ul style="list-style-type: none"> • LED technology • White light 2.000 cd, night mode • 20 fpm to 30 fpm • Horizontal beam radiation 360° • Vertical beam spread >1° • PMMA lens • Light output alignment device 		<ul style="list-style-type: none"> • Anodised aluminium body, painted yellow • Borosilicate glass cover protection • Silicon rubber, VMQ • Base wind collector and internal heat sink for optimum cooling • Ingress protection: IP-66 • Anti-condensation Gore-Tex valve • Operating temperature: -30°C to +50°C • Lamp unit weight: 6 kg
Electrical Features		Box Mechanical Features	
	<ul style="list-style-type: none"> • Anodised aluminium body, painted yellow • LED feeded at constant current • No RF - Radiations 		<ul style="list-style-type: none"> • Enclosure material: mild steel, painted RAL 7035 • Surge arrester • Fault alarm • Photocell (twilight sensor) • Overvoltage protection
Power supply	110-230 VAC 24 VDC		
Options		Certifications	
	<ul style="list-style-type: none"> • Beacon support bracket • GPS (Global Position System) syncro • White/Green alternate flashes for land aerodromes instead of white flashes only (-LAND) 		<ul style="list-style-type: none"> • CE marking
		Compliance	
			<ul style="list-style-type: none"> • ICAO Aerodromes -Annex 14 Volume 1, Par. 5.3.3 "Aeronautical Beacon"



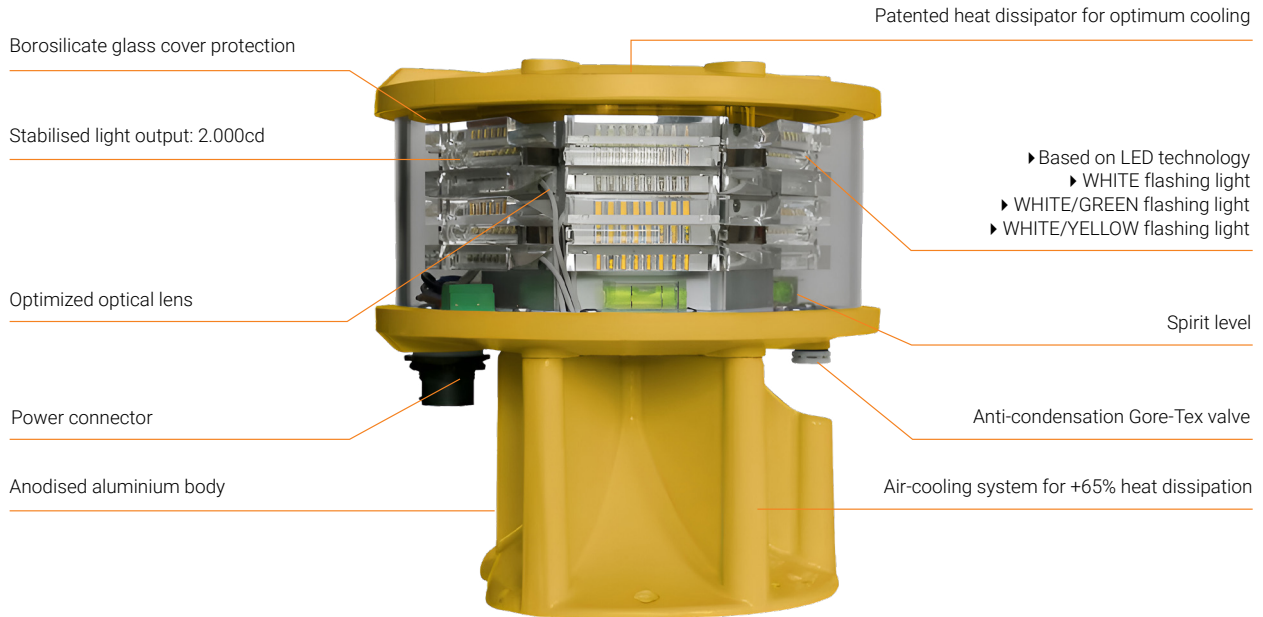

NOTE: electronic beacon driver in a separate enclosure

IP66

TECHNICAL DRAWING

BEACON FRONT VIEW

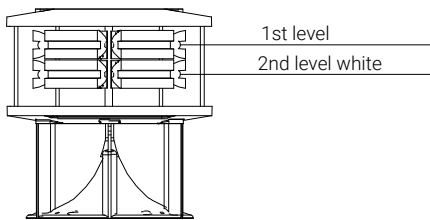

BEACON SIDE VIEW

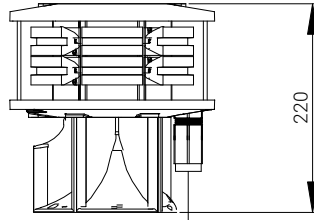

BEACON TOP

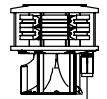
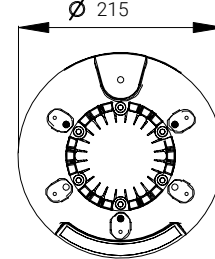

Incoming power supply cable
C/W connector (cable O.D. 7/14mm, Max size 2.5sqmm)

FIXING DETAILS

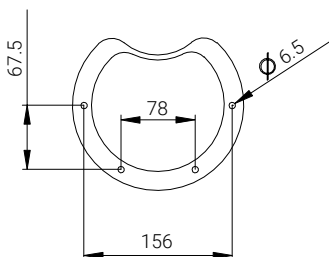

CONTROLLER

